

# Fun Home Art Projects

## How to Draw the Statue of Liberty

**DID YOU KNOW?** The Statue of Liberty stands 305 feet, from the base of the pedestal foundation to the tip of the torch. Lady Liberty has a 111-foot waistline and weighs 225 tons. The Official dedication ceremony was held on Thursday, October 28, 1886.

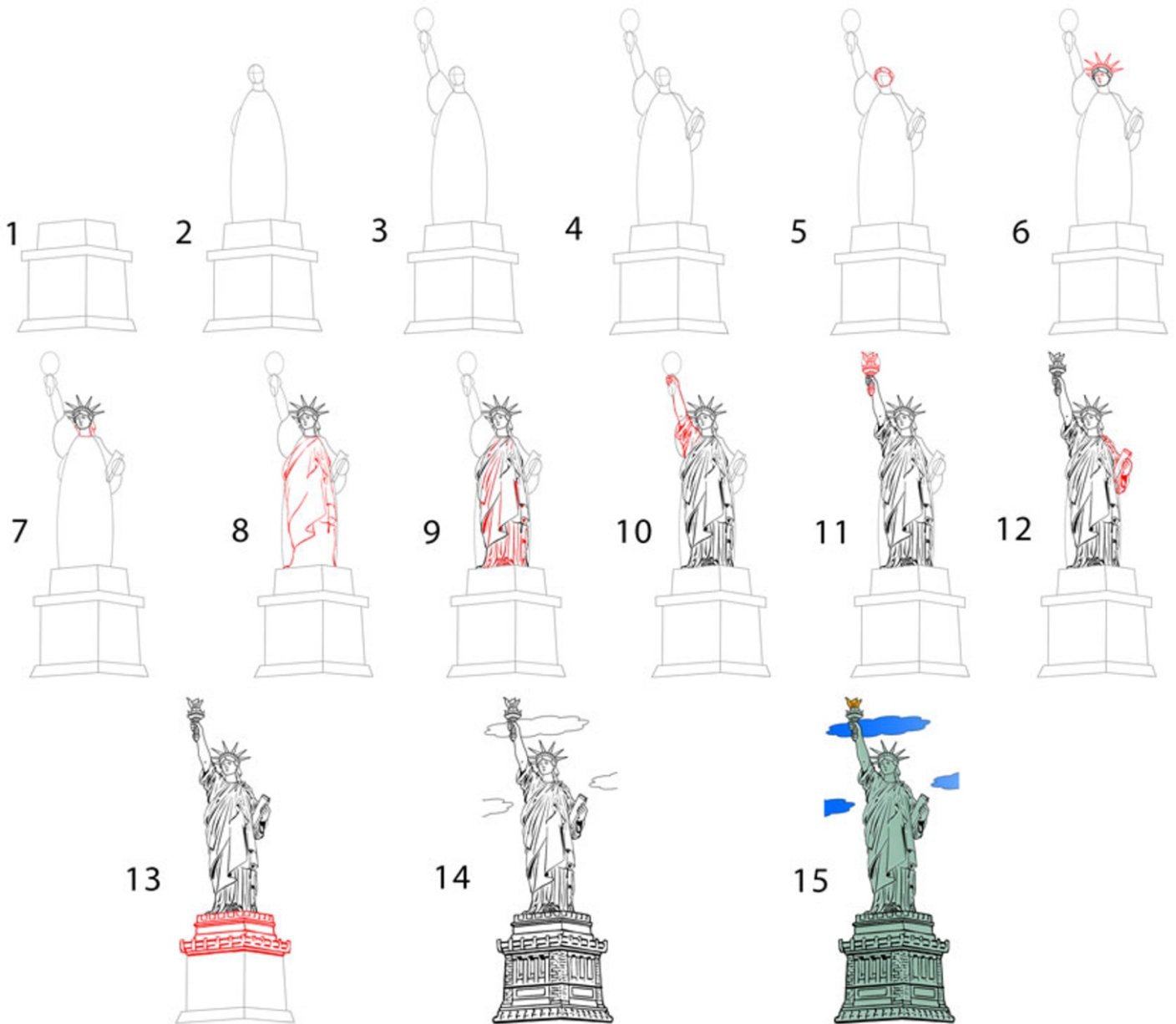

# Fun Home Art Projects

## How to Draw the Statue of Liberty

1

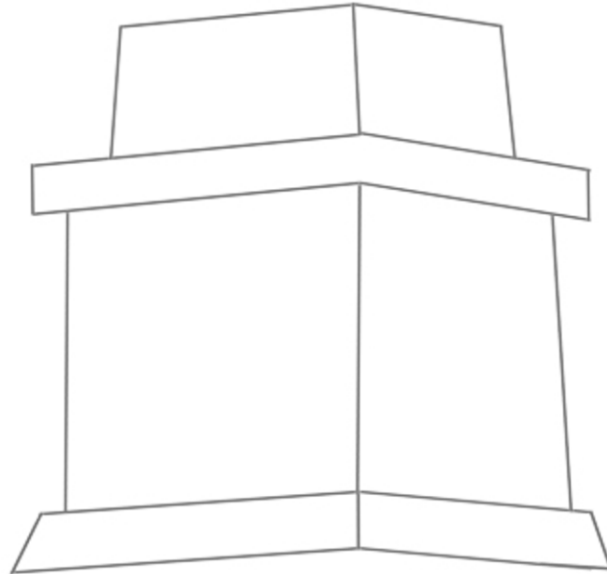

# Fun Home Art Projects

## How to Draw the Statue of Liberty

2

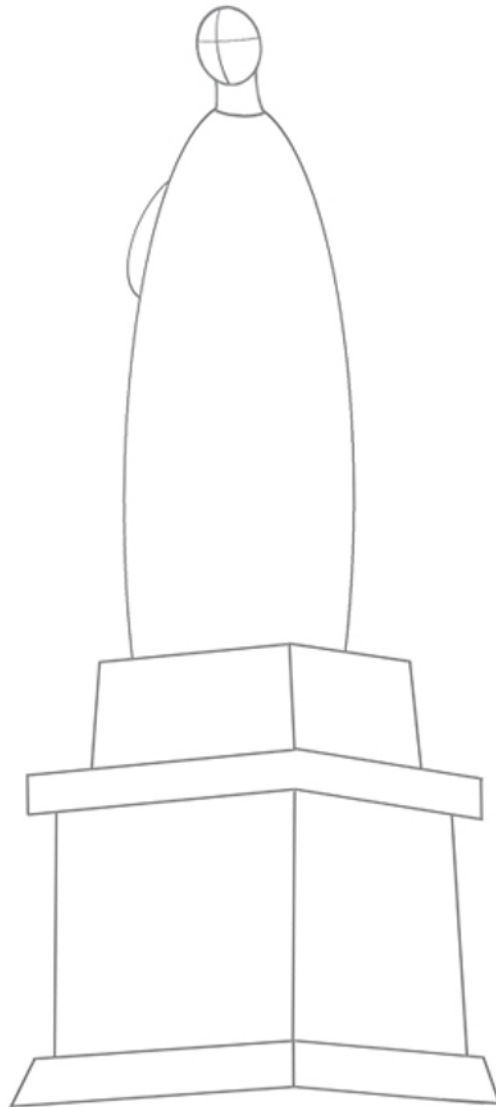

# Fun Home Art Projects

## How to Draw the Statue of Liberty

3

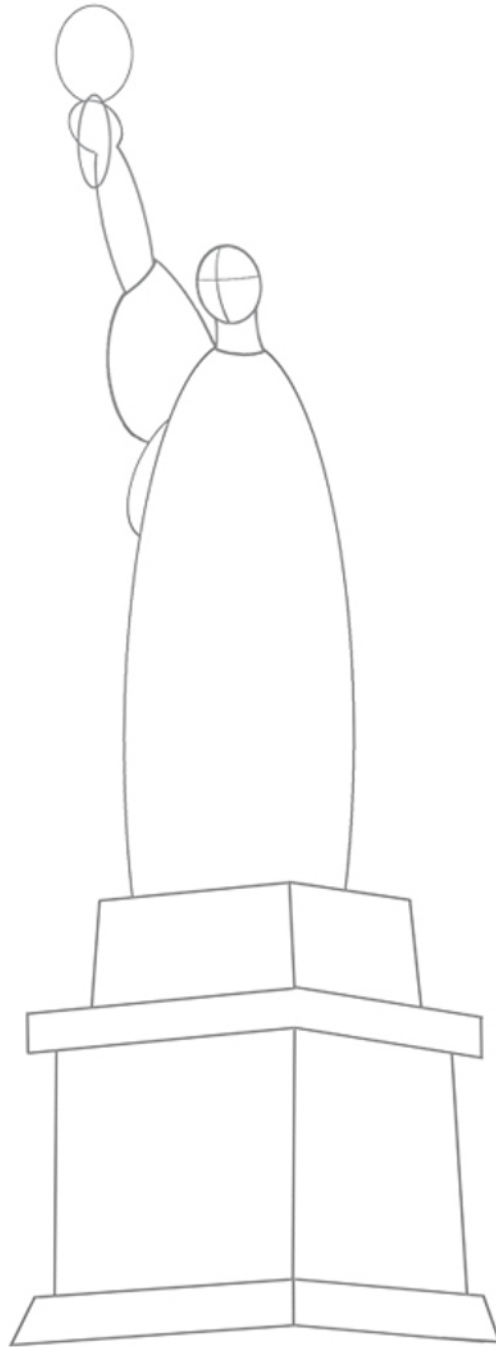

# Fun Home Art Projects

## How to Draw the Statue of Liberty

4



# Fun Home Art Projects

## How to Draw the Statue of Liberty

5



# Fun Home Art Projects

## How to Draw the Statue of Liberty

6



# Fun Home Art Projects

## How to Draw the Statue of Liberty

7





# Fun Home Art Projects

## How to Draw the Statue of Liberty

8



# Fun Home Art Projects

## How to Draw the Statue of Liberty

9



# Fun Home Art Projects

## How to Draw the Statue of Liberty

10



# Fun Home Art Projects

## How to Draw the Statue of Liberty

11



# Fun Home Art Projects

## How to Draw the Statue of Liberty

12



# Fun Home Art Projects

## How to Draw the Statue of Liberty

13



# Fun Home Art Projects

## How to Draw the Statue of Liberty

14



# Fun Home Art Projects

## How to Draw the Statue of Liberty

15

